

Roof Opening Panel (76.84.01)

Removal

- 1 . Remove the headliner.
For additional information, refer to : Interior Trim and Ornementation, 501-05.
- 2 . Release the 4 drain hoses from the roof opening panel.
- 3 . Disconnect the roof opening panel motor electrical connector.

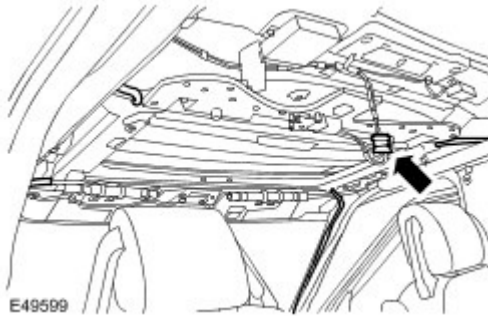

- 4 . With assistance, remove the roof opening panel assembly.
▶ Remove the 11 bolts.

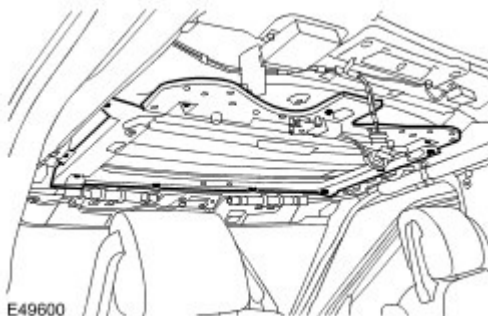

- 5 .  **CAUTION : Do not depress the RH plunger to remove the blind.**

NOTE :

Do not disassemble further if the component is removed for access only.

NOTE :

Note the fitted position.

Remove the roof opening panel blind.

▶ Twist to release the handle.

▶ Depress the LH plunger.

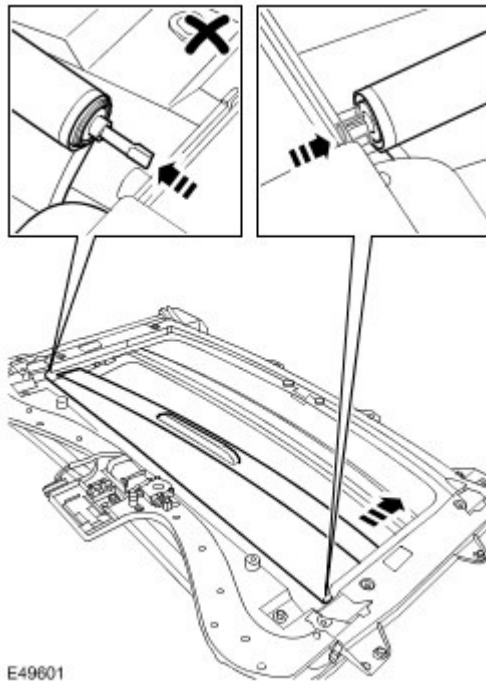

- 6 . Remove the roof opening panel motor.
- Remove the 3 Torx screws.
 - Remove the spacer.

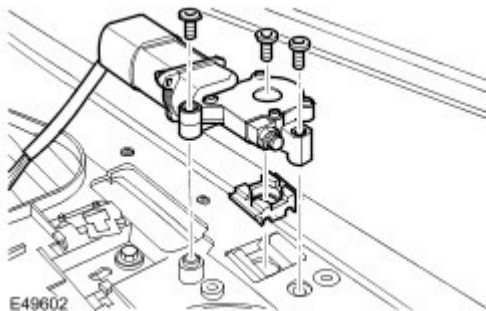

Installation

- 1 . Install the roof opening panel motor.
- Install the spacer.
 - Tighten the Torx screws to 4 Nm (3 lb.ft).

2 . **NOTE :**

Align to the position noted on removal.

Install the roof opening panel blind.

- Secure in the guides.
- Locate the tensioner peg.
- Depress the LH plunger.

- 3 . With assistance, install the roof opening panel assembly.

- Clean the component mating faces.

 Tighten the bolts to 10 Nm (7 lb.ft).

4 . Connect the roof opening panel motor electrical connector.

5 . Connect the drain hoses.

 Make sure the drain hoses are clear prior to connection.

6 . Install the headliner.

For additional information, refer to : Interior Trim and Ornamentation, 501-05.

7 . Using T4, configure a new roof opening panel.

8 . If the battery has been disconnected, the one touch and anti-trap function will become inoperative. Close the roof opening panel and continue to hold the switch for a further 20 seconds to allow the sunroof to complete a full cycle. This will complete the roof opening panels calibration routine and reset these functions.